

Taking the ALEKS Assessment

Tip for taking the ALEKS:

- It is important the ALEKS Assessment is taken seriously **without the use of a calculator or other technology** and without help from other individuals.
- Each student should give their best effort on the assessment so their score truly reflects their **current level of math preparedness**.
- There is no benefit to cheating on the assessment** or consulting outside sources. The purpose is to measure a student's current mathematical knowledge so that they will be successful in their first mathematics course.
- Make sure to **submit** your assessment **before the end of your 2 hour time limit**. This will register your score in the system and generate your individualized learning modules.

Step 1: Access the ALEKS assessment through your CU Denver UCD Access student portal <https://passport.ucdenver.edu/login.php>.

The screenshot shows the CU Denver UCD Access student portal dashboard. The top navigation bar includes the CU Denver logo, the name 'Denver | Anschutz', a search bar, and utility icons. The main content area is divided into several sections:

- Student Center:** A grid of icons for Academics, Admissions, Advisor, Class Search, Student Account, Financial Aid, Register for Classes (add/drop), Profile, Tasks - Holds, and Tasks - To-Do Items.
- Student Schedule:** A calendar view for Spring 2024 showing classes for Monday, Wednesday, and Thursday. The Thursday column is highlighted in blue. Classes listed include CSCI 5575 NRTH 3202 Hybrid Enrolled.
- Quick Links:** A vertical list of buttons for Canvas, WebMail, Degree Audit, CU Denver Calendars, and Campus Closures.
- Student Resources:** A vertical list of buttons for CU Denver Handshake, **ALEKS Math Placement** (highlighted with a red box), LinkedIn Learning, and Start Skillsoft. A red arrow points to this section.
- Apply for Scholarships:** A button with a ribbon icon.
- CU Resources:** A button with the CU Denver logo.

Step 2:

If this is your first time setting up an ALEKS account please select No, I have never used ALEKS before.

If you have already used ALEKS please select Yes, and use your original credentials. You may disregard steps 3 and 4 if they do not apply to you

ALEKS

Welcome to ALEKS!

Have you used ALEKS before?

No, I have never used ALEKS before.

Yes, I have an ALEKS login name.

Log Into Account

ALEKS Login Name:

Password:

[I forgot my login information >](#)

Step 3: Read and accept the Terms of Use and then hit continue.

User Agreement

Review and Accept Terms of Use

I agree to the [Terms of Use](#)

Step 4:

You should see the confirmation below. Please hit continue at the bottom of the screen.

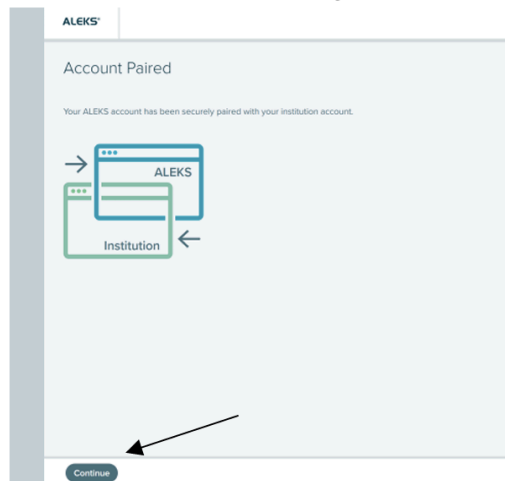

Step 5: You are now in the ALEKS Placement Portal. To start your assessment click where it says “Enter your class here.”

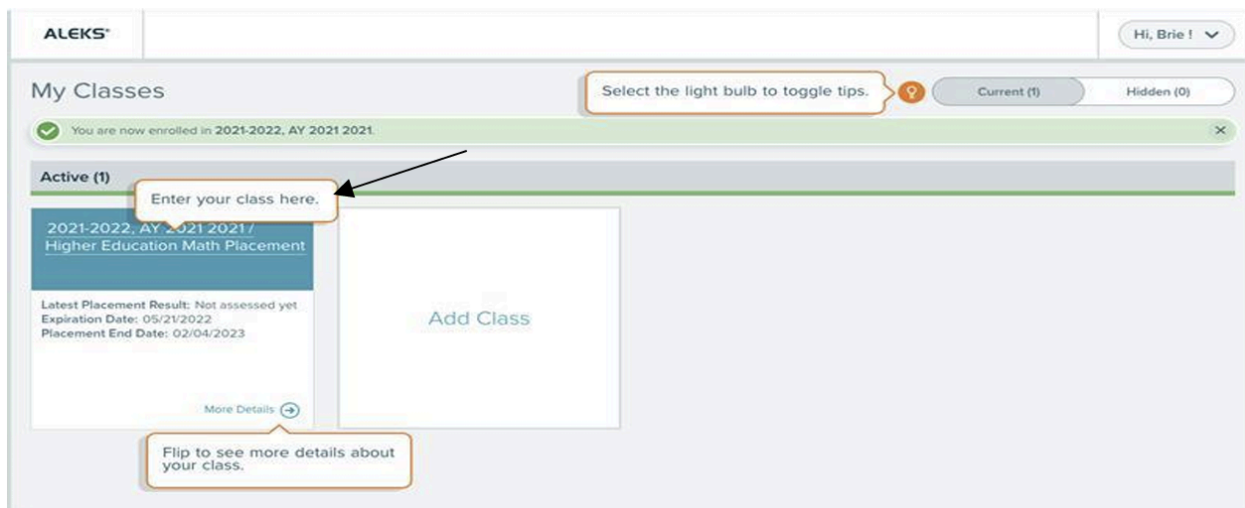

IMPORTANT: Each student will have one account that expires *1 year after set-up*. If you have not taken your first assessment in this time period contact math.placement@ucdenver.edu to reset your account..

Step 6:

Once you have completed your first assessment you will be assigned learning modules based on your proficiency in each Sub topic. Please complete 5 hours of modules to unlock your second attempt, and 3 hours for each subsequent attempt. Progress towards completion can be found on the left hand side of the main assessment page.